

EV-EM-TIMER-BASIC

CONTACTOR WIRING

The Emergency Test Switch is designed to be used with a Normally Closed (NC) contactor.

Ensure emergency circuits power fittings are in the same area as the matching regular lighting circuit. Join each emergency circuit neutral to earth lighting circuit neutral separately.

Monitored wiring is only used within centrally supplied systems

Connect to regular lighting after MCB/RCD

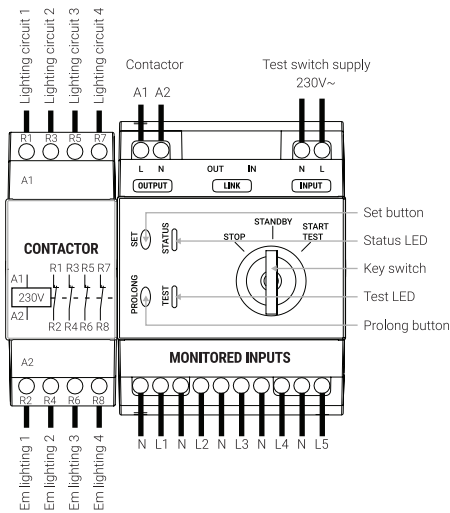

Connect to emergency lighting

STATUS INDICATOR TABLE

INDICATOR	STATUS	DESCRIPTION
SET	○ ON	Test duration is set on 120 minutes
	● OFF	Test duration is set on 90 minutes
PROLONG	○ ON	Prolong enabled
	● OFF	Prolong disabled
	◐ FLASHING	Prolong in progress (15 min)
STATUS	○ ON	Normal operation
	● OFF	No power
	◐ FLASHING	Emergency condition detected
	2x FLASH	Commission successful
TEST	○ ON	Test running
	● OFF	No test running
	◐ FLASHING	Test standby timer running (45 min)

EMERGENCY TEST SWITCH COMMISSIONING

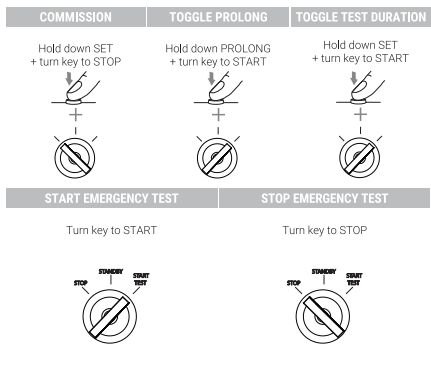

OVERVIEW

The Emergency Test Switch can monitor up to 5 lighting circuits and triggers a relay/contactor if any of the monitored lines fail. The device also has a key input which is used to start and stop emergency tests by triggering the relay/contactor. The buttons on the Emergency Test Switch are used for commissioning purposes (i.e. Enable/Disable Prolong, Set Duration Time, Enable/Disable Monitoring Lines). Multiple Emergency Test Switches can also be used together by connecting the devices via interlinking cable, this feature will only monitor interconnect fault conditions and is not triggered if the device is in a test.

WHY USE AN EMERGENCY TEST SWITCH

The Emergency Test Switch is an emergency test timer as well as a circuit monitoring device and complies to AS 2293.1:2005 Sensing of supply failure (2.3.3). The Emergency Test Switch also provides additional features such as prolong, where the devices can remain in emergency mode for an extended time allowing HID lights time to relight (AS 2293.1:2005 2.3.2). For more information refer to AS 2293.1.

EV-EM-TIMER-BASIC

SPECIFICATIONS

Voltage	220-240V~	Max. Power Consumption	2.3W
Frequency	50/60 Hz	IP rating	IP20
Ambient temp.	50°C	Mounting type	Wall/ field mount

Emergency test switch

Relay connection	Screw terminal for 1 to 6mm ² cable
Relay type	4 pole non-latching
Relay Load	16A 240V~ maximum
Supply Connection	Screw terminal for 1 to 4mm ² cable

DIMENSIONS

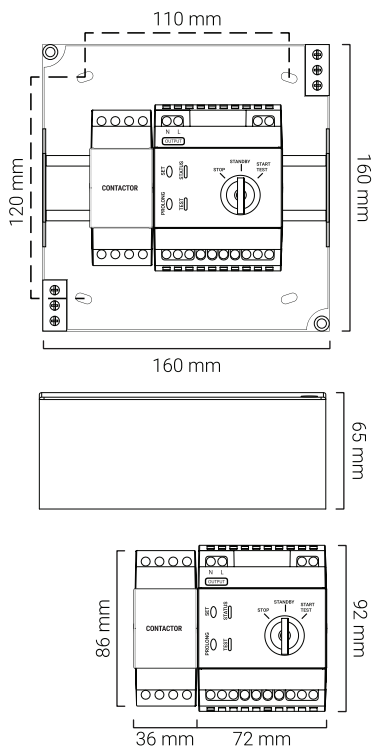

SAFETY WARNINGS

1. This product must only be installed by a suitably qualified person.
2. Before commencing installation turn off and isolate the electrical supply.
3. Do not touch the terminal block or circuitry when the Emergency Test Switch is energised.
4. There are no user serviceable parts. Do not attempt to service other parts as this will void the warranty.
5. As the installer, it is your responsibility to ensure you comply to all relevant building and safety codes. Refer to application standards for the relevant rules, for example the BCA, AS3000. Refer to the application standards for the relevant rules.
6. When installation is complete, please leave this manual with the building's owner(s) for future reference.

EV-EM-TIMER-BASIC

TROUBLE SHOOTING

PROBLEM

Emergency lights are on in normal operation

POSSIBLE CAUSE

- Not using normally-closed contactor
- Monitored inputs haven't been commissioned

SUGGESTED REMEDY

- Make sure you're using a normally-closed contactor
- Commission emergency timer (see emergency test switch commissioning)

If emergency lights stay on after one or all the monitored inputs fail

- Monitored inputs haven't been commissioned

- Commission emergency timer (see emergency test switch commissioning)

If emergency lights are still on after 90/120 minutes have passed

- Extra 45 minutes timer at the end of test to check results of each fitting (Test LED flashing)

- Wait the rated duration time plus 45 minutes

Emergency lights stay on after testing

- Prolong enabled (Prolong LED flashing)

- Disable prolong if not required (see emergency test switch commissioning)

WARRANTY STATEMENT

Ektor products are distributed in Australia and New Zealand by Evolt Pty Ltd (Evolt). The Australian Consumer Law as well as other Australian laws guarantee certain conditions, warranties and undertakings, and give you other legal rights, in relation to the quality and fitness for purpose of Ektor products sold in Australia. In Australia, our goods come with guarantees that cannot be excluded under the Australian Consumer Law. You are entitled to a replacement or refund for a major failure and compensation for any other reasonably foreseeable loss or damage. You are also entitled to have the goods repaired or replaced if the goods fail to be of acceptable quality and the failure does not amount to a major failure. What constitutes a major failure is set out in the Australian Consumer Law. Nothing in this Warranty purports to modify or exclude the conditions, warranties and undertakings, and other legal rights, under the Australian Competition and Consumer Act and other Australian laws. Ektor products are warranted in Australia for a period of 3 years from the date of delivery of the product, provided that the products are properly stored, installed, used and maintained in accordance with the instructions contained within their manual. Products that have been altered in any way or used other than in accordance with their instructions are not covered by this warranty.

This warranty is not transferable and is valid only in the hands of the purchaser of the product. The warranty does not cover Ektor products other than those purchased from Evolt. Proof of purchase must be provided to Evolt with any warranty claim. Evolt recommends that the purchaser attaches their proof of purchase to their product manual. Evolt's total liability under this warranty is limited to the cost of repair or replacement of the faulty product. Evolt may satisfy its obligations under this warranty in full by repair or replacement of a faulty product. This warranty does not apply to consumable items such as lamps or batteries or other items that can be classified as consumable. For the avoidance of any doubt, any and all warranties or conditions which are not guaranteed under the Australian Competition and Consumer Act or the Australian Competition and Consumer Regulations 2010 and which are not expressly included in this Warranty as additional warranties or conditions are excluded. This Warranty does not cover loss or damage caused by wear and tear, misuse, incorrect installation or operation, failure to clean and maintain, incorrect voltage or non-authorized electrical connections, adverse external conditions (such as power surges and dips, acts of God, exposure to heat, corrosion, insect or vermin infestation), use of non-authorized or defective parts or globes, or to items that have been repaired other than by Evolt or a repairer approved by Evolt.

TECHNICAL SUPPORT AND TROUBLESHOOTING

For further assistance in using this product, consult your nearest wholesaler or Evolt Pty Limited