

## EV-RAZOR-FLEX-PRO-24M

## 17740

### INSTALLATION

Remove the product from the box and inspect it for any damage. If you believe the product to be damaged or otherwise unsound, **DO NOT** install the product. Please pack it back into its box and return it to the place of purchase for replacement.

#### CEILING MOUNT

1. Drill 15-44mm hole for cable entry in ceiling.

2. Attach surface mount supports with supplied screws into exit. Leave min 3mm between top of sign and screw head.

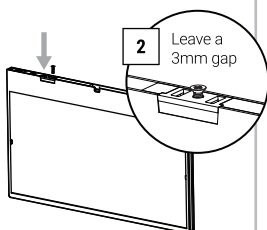

3. Insert cable through slot on bracket

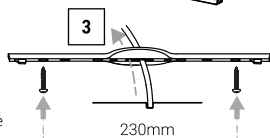

4. Attach bracket to ceiling using appropriate mounting screws

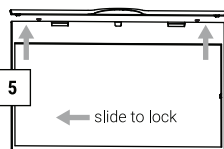

5. Attach to ceiling bracket, slide to secure. If fitting feels loose after installation slightly tighten the support screws.

#### WALL MOUNT

1. Drill 20mm hole for cable entry. Ensure the hole is behind the bracket and not visible.

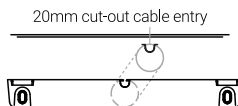

2. Attach wall mount bracket using appropriate mounting screws (not included).

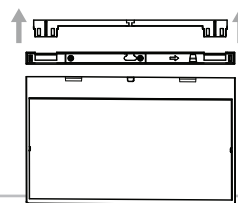

#### CONNECT TO EMERGENCY DRIVER

1. Connect the cable between the socket on the exit and the smart emergency input socket on the driver.

2. After installing the Razor Flex attach the cable to the smart emergency port.

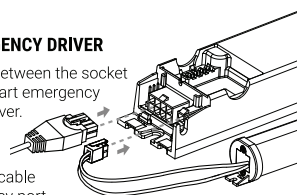

### SAFETY WARNINGS

1. This product must only be installed by a suitably qualified person.
2. Before commencing installation turn off and isolate the electrical supply.
3. Supply voltages within product. Isolate supply voltages before opening or servicing.
4. There are no user serviceable parts. Do not attempt to service other parts as this will void the warranty.
5. As the installer, it is your responsibility to ensure you comply to all relevant building and safety codes. Refer to application standards for the relevant rules.
6. When the ac power is cut or when pressing the test button, the luminaire will operate in emergency mode.
7. The light source contained in this luminaire shall only be replaced by the manufacturer or his service agent or a similar qualified person.
8. Supply voltages within isolate supply before opening.
9. Do not insulation test over 500vdc.
10. The rechargeable device will operate normally after the removal of short circuit fault.
11. The luminaire is connected to an unswitched active during normal operating conditions. When disconnected from the mains supply, the luminaire is powered by a LiFePO<sub>4</sub> battery operated inverter. Due to this, care should be taken when replacing the battery.

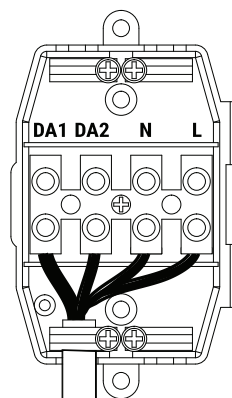

## ORDER INFORMATION

Order code	SKU	Description
EV-RAZOR-FLEX-PRO-24M	17740	Razor Flex Pro Slimline Emergency Edgelit Exit 24M

## DIMENSIONS (MM)

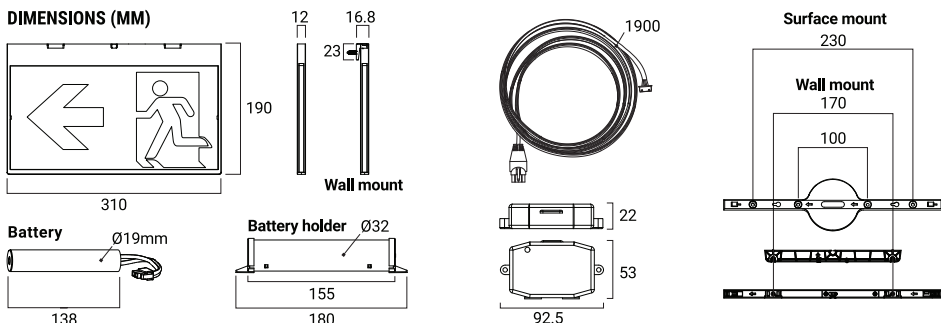

## SPECIFICATIONS

<b>Voltage</b>	240V~	<b>Class</b>	2	<b>Wiring</b>	Terminal block
<b>Frequency</b>	50 Hz	<b>Rated duration</b>	90 / 120 min	<b>Operation</b>	Maintained
<b>Ambient temp.</b>	0 to 45°C	<b>IP rating</b>	IP20	<b>Battery spec</b>	6.4 V 1500mAh
<b>Lamp power</b>	1.0W	<b>Mounting type</b>	Wall and ceiling	<b>Battery type</b>	LiFePO <sub>4</sub>

## REPLACING THE BATTERY

Access the battery by removing the product cover. Disconnect and remove battery. Replace battery as was previously installed. Allow a minimum 24 hours charging time before carrying out any discharge tests as per the requirements in AS/NZS 2293.

## STATUS CHARGE LEDS (GREEN)

Indicator	Description
<b>Illuminated</b>	Device is in normal mode
<b>Slow flash</b>	Test switch button has been pressed/held for any amount of time, and is not in any self tests
<b>Off</b>	Battery failure
<b>1x flash</b>	A duration test is pending, the device is not in any self test but set to normal mode
<b>2x flash</b>	Lamp failure
<b>4x flash</b>	Interface failure
<b>5x flash</b>	No DALI address
<b>7x flash</b>	Device performing function test. The test was triggered by a DALI command or function test interval
<b>9x flash</b>	Device either doesn't support maintained mode or doesn't support the selected duration setting

## BATTERY LIFE

- Battery minimum life is 4 years, and can only be used under emergency mode.
- Once the battery can no longer meet the required rated duration it must be replaced.
- To maintain the economic life of this product it is required that the battery be discharged and recharged at least once every 6 months. The battery life can be reduced if the battery is not discharged.

1 x LiFePO<sub>4</sub> stick battery (01302)



## STATUS LEDS (YELLOW)

Indicator	Description
<b>Illuminated</b>	Indicates that the device is in normal mode
<b>0.5sec ON 0.5sec OFF</b>	Last duration test failed, failed to meet duration. The device is not currently running a new test. Mains is on
<b>2sec ON 2sec OFF</b>	Device is performing a duration test
<b>4sec ON 1sec OFF</b>	Last duration test passed, the duration was met when last run. Test ran less than 30 days ago