

## EV-RAZOR-SWING-24M-PRO-B

Swing slimblade Emergency Exit, Black

### INSTALLATION

- 1 Remove mounting base by using a flat-blade screwdriver to release locking tabs.

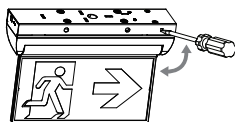

- 2 Slide body along the base in the direction marked to separate from mounting base.

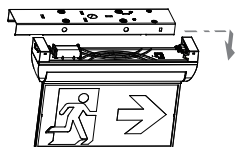

### FLUSH MOUNT

- 1 Use the mounting base as a template to mark holes for screws and cable access prior to drilling. Securely fix the mounting base to the fixing surface with screws and rawl plugs provided.

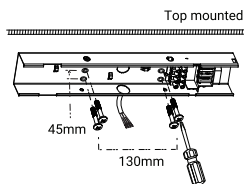

- 2 Complete wiring and re-assemble by sliding the body back into the mounting base. The Razor Swing makes an electrical connection to the terminals on the mounting base when re-assembled.

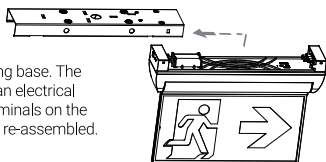

### DIMENSIONS

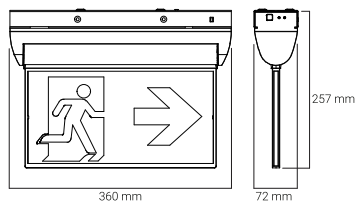

### DISCHARGE RATING SELECTION

The inverter supports a number of discharge ratings which can be selected by the user. The output from the LED scales based on the discharge rating.

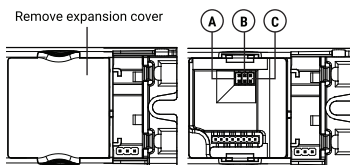

### HOURS

	A	B	C
1 Hour	OFF	OFF	OFF
2 Hours (default)	ON	ON	ON
3 Hours	ON	ON	OFF
4 Hours	ON	OFF	ON
8 Hours	ON	OFF	OFF
Central battery operation	OFF	ON	OFF

## EV-RAZOR-SWING-24M-PRO-B

Swing slimblade Emergency Exit, Black

### SPECIFICATIONS

<b>Voltage</b>	240V~	<b>Rated duration</b>	90 / 120 min	<b>Battery spec</b>	6.4 V 1500mAh
<b>Frequency</b>	50 Hz	<b>IP rating</b>	IP20	<b>Battery type</b>	LiFePO <sub>4</sub>
<b>Ambient temp.</b>	0 to 40°C	<b>Mounting type</b>	Surface Mount		
<b>Lamp power</b>	0.7W	<b>Wiring</b>	Terminal block		
<b>Class</b>	I	<b>Operation</b>	Non-maintained		

### STATUS CHARGE LEDS (GREEN)

Indicator	Description
<b>Illuminated</b>	Device is in normal mode
<b>Slow flash</b>	Test switch button has been pressed/held for any amount of time, and is not in any self tests
<b>1x flash</b>	A duration test is pending, the device is not in any self test but set to normal mode
<b>2x flash</b>	Lamp failure
<b>3x flash</b>	Battery failure
<b>4x flash</b>	Interface failure
<b>5x flash</b>	No DALI address
<b>7x flash</b>	Device performing function test. The test was triggered by a DALI command or function test interval
<b>9x flash</b>	Device either doesn't support maintained mode or doesn't support the selected duration setting

### STATUS LEDS (YELLOW)

Indicator	Description
<b>Illuminated</b>	Indicates that the device is in normal mode
<b>0.5sec ON 0.5sec OFF</b>	Last duration test failed, failed to meet duration. The device is not currently running a new test. Mains is on
<b>2sec ON 2sec OFF</b>	Device is performing a duration test
<b>4sec ON 1sec OFF</b>	Last duration test passed, the duration was met when last run. Test ran less than 30 days ago



### SAFETY WARNINGS

1. This product must only be installed by a suitably qualified person.
2. Before commencing installation turn off and isolate the electrical supply.
3. Supply voltages within product. Isolate supply voltages before opening or servicing.
4. There are no user serviceable parts. Do not attempt to service other parts as this will void the warranty.
5. As the installer, it is your responsibility to ensure you comply to all relevant building and safety codes. Refer to application standards for the relevant rules.
6. When the ac power is cut or when pressing the test button, the luminaire will operate in emergency mode.
7. The light source contained in this luminaire shall only be replaced by the manufacturer or his service agent or a similar qualified person.
8. Supply voltages within isolate supply before opening.
9. Do not insulation test over 500vdc.
10. The rechargeable device will operate normally after the removal of short circuit fault.
11. The luminaire is connected to an unswitched active during normal operating conditions. When disconnected from the mains supply, the luminaire is powered by a LiFePO<sub>4</sub> battery operated inverter. Due to this, care should be taken when replacing the battery.