

EV-RAZOR-SWING-PRO

14545

Remove the product from the box and inspect it for any damage. If you believe the product to be damaged or otherwise unsound, **DO NOT** install the product. Please pack it back into its box and return it to the place of purchase for replacement. If the product is satisfactory, proceed with the installation. Prior to installation, components may require disassembly prior to fitment.

1

When attached to the main body, the Razor-Swing mounting base must be removed by firstly using a flat-bladed screwdriver to release locking tabs (as shown).

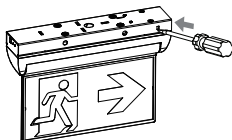

2

Slide the Razor-Swing body along the base in the direction marked to separate from mounting base.

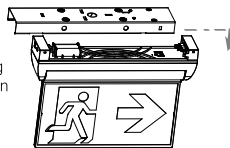

FLUSH MOUNT

1

Utilise the mounting base as a template to mark holes for screws and cable access prior to drilling. Securely fix the mounting base to the fixing surface with screws and rawl plugs provided.

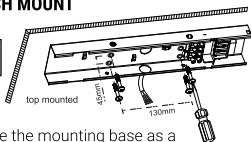

2

Secure the base in place and complete wiring. Re-assemble by sliding the Razor-Swing body back into the mounting base. The Razor-Swing makes an electrical connection to the terminals on the mounting base when re-assembled.

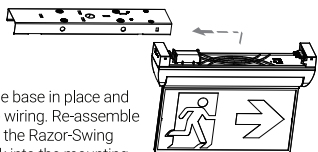

SAFETY WARNINGS

1. This product must only be installed by a licensed electrician.
2. Before commencing installation turn off and isolate the electrical supply.
3. Do not energise with product open or disassembled.
4. Supply voltages within product. Isolate supply voltages before opening or servicing.
5. There are no user serviceable parts. Do not attempt to service other parts as this will void the warranty.
6. As the installer, it is your responsibility to ensure you comply to all relevant building and safety codes. For example the BCA, AS3000. Refer to application standards for the relevant rules.
7. Indicator is flashing when charging, is luminated green when fully charged, and turns off when battery failure.
8. When the ac power is cut or when pressing the test button, the luminaire will operate in emergency mode.
9. The light source contained in this luminaire shall only be replaced by the manufacturer or his service agent or a similar qualified person.
10. Do not insulation test over 500vdc.

TERMINAL BLOCK

Wiring schematic for the terminal block used with the Razor-Swing PRO.

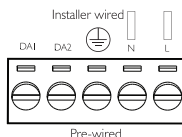

REPLACING THE BATTERY

Access the battery by removing the product cover. Disconnect and remove battery. Replace battery as was previously installed. Allow a minimum 24 hours charging time before carrying out any discharge tests as per the requirements in AS/NZS 2293.

⚠ WARNING

The luminaire is connected to an unswitched active during normal operating conditions. When disconnected from the mains supply, the luminaire is powered by a LiFePO₄ battery operated inverter. Due to this, care should be taken when replacing either the battery.

ORDER INFORMATION

Order code	Description	Carton QTY.
EV-RAZOR-SWING-PRO 14545	Razor-Swing Professional Adjustable Emergency Exit	4

DIMENSIONS (MM)

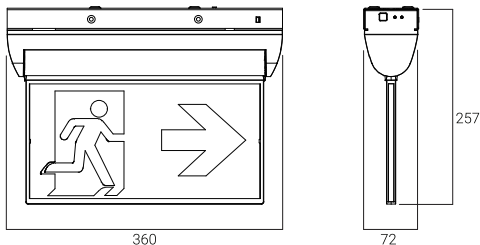

SPECIFICATIONS

Voltage	220-240 V	Duration	90 / 120 min	Battery spec	6.4V 1000mAh
Frequency	50 Hz	IP rating	IP20	Battery type	LiFePO ₄
Max. ambient temp.	40°C	Mounting type	Surface / wall mount	Battery supply current	175mA
Class	1	Wiring	Terminal Block	Charging time	16 hours
Maintained power cons.	Max. 3.5W Avg. 2.5W	Viewing Distance	24M	Charger type	Multi-state
		Classification	C0:E6.3, C90:E16	Projected light source life	30Y/00M

ACCESSORIES AND SPARE PARTS

Order code	Description
01300	Battery - LiFePO ₄ 6.4V 100mAh
02978	Razor 24M decal pack

BATTERY LIFE

- Battery minimum life is 4 years, and can only be used under emergency mode.
- Once the battery can no longer meet the required rated duration it must be replaced.
- To maintain the economic life of this product it is required that the battery be discharged and recharged at least once every 6 months. The battery life can be reduced if the battery is not discharged

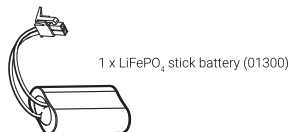

SPACING TABLE (DISTANCE BETWEEN FITTINGS)

Lx	Classification	Mounting Height (M)															
		2.1	2.4	2.7	3.0	3.3	3.6	4.0	4.5	5.0	6.0	7.0	8.0	9.0	10	15	20
0.2	E6.3	6.9	7.4	7.9	8.2	8.5	8.8	9.1	9.2	9.3	0.0 ⁴	0.0 ⁴	0.0 ⁴	N/A	N/A	N/A	N/A
	E16	8.3	9.1	9.8	10.4	11.0	11.5	12.1	12.8	13.4	14.2	14.7	14.7	0.0 ⁴	0.0 ⁴	N/A	N/A