

## UMBRA ADVANCED WIREGUARD EMERGENCY

Remove the product from the box and inspect it for any damage. If you believe the product to be damaged or otherwise unsound, **DO NOT INSTALL** the product. Please pack it back into its box and return it to the place of purchase for replacement. If the product is satisfactory, proceed with the installation.

### MOUNTING

1. Remove cover by first loosening the end cap screws and pulling the end cap carefully outward. The cover can then be removed by sliding out from one side before lifting up. It may be necessary to loosen both ends.

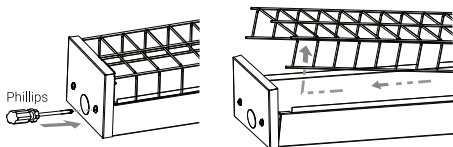

2. Select the light CCT from between 4000K, 5000K and 6500K, utilising the switch located on the back of the gear tray.

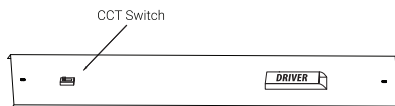

3. Select the required power/ lumen output utilising the DIP switches located on the driver on the back of the gear tray and referencing the DIP switch setting instructions on the following page.

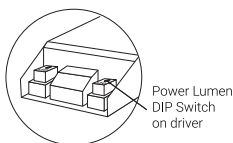

4. With cover (A) detached unscrew three screws holding the gear tray in place and remove gear tray.
5. Mount batten onto surface using mounting holes (B), use appropriate fasteners.
6. Wire terminal block, replace geartray, tubes and cover.

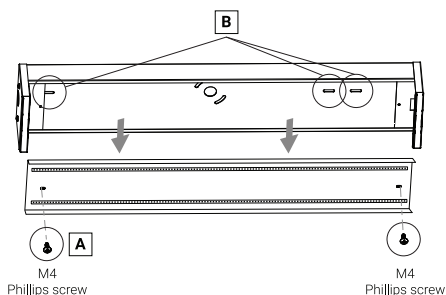

7. Terminate mains cable into terminal block (Refer to Class I Wiring details).  
Wiring schematic for the terminal block used with the Umbra Advanced.  
L' is the switched active line used to power the normal lighting.

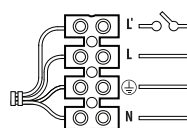

8. Refit gear tray, taking care that cables do not become trapped or pinched.

### SAFETY WARNINGS

1. This product must only be installed by a licensed electrician.
2. Before commencing installation turn off and isolate the electrical supply.
3. Risk of accidental contact with live parts. Do not energise with product open or disassembled.
4. Supply voltages within product. Isolate supply voltages before opening or servicing.
5. As the installer, it is your responsibility to ensure you comply to all relevant up to date building and safety codes and as/nzs 3000 wiring rules. Refer to application standards for the relevant rules.
6. The light source of this luminaire is not user replaceable; when the light source reaches end of life the whole luminaire shall be replaced.
7. As the installer, it is your responsibility to ensure you comply to all relevant building and safety codes for example the latest versions of the bca, as/nzs 3000. Refer to application standards for the relevant rules.



**NOTE: UMBRA ADVANCED  
BATTENS ARE NOT  
SUITABLE FOR DIMMING**



**WARNING: CAUTION -  
RISK OF ELECTRIC SHOCK**

## DIMENSIONS

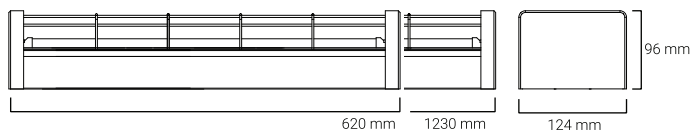

## SPECIFICATIONS

<b>Voltage</b>	230V~	<b>Duration</b>	90 / 120 min	<b>Battery Type</b>	LiFePO4
<b>Frequency</b>	50Hz	<b>IP Rating</b>	IP20	<b>Battery Capacity</b>	6.4V 1500mAh
<b>Class</b>	I	<b>Sdcm</b>	<4	<b>Battery Code</b>	01302
<b>Working Temp. Range</b>	0 - 40°C	<b>Lifetime</b>	L70 B10 (9K) >50,000 Hrs	<b>Charging Time</b>	16 Hours
<b>CRI</b>	>80	<b>Wiring</b>	Terminal Block	<b>Charger Type</b>	Variable
<b>CCT</b>	4000K, 5000K, 6500K	<b>Mounting Type</b>	Surface Mounted	<b>Warranty</b>	3 Years
<b>Emerg. Class</b>	C0:D63, C90:D32 (600mm)				
	C0:D63, C90:D40 (1200mm)				

## TOTAL POWER CONSUMPTION (TPC)

Model	LED Output	Maintained (Lamp on)		Non-maintained (Lamp off)	
		Avg.	Max.	Avg.	Max.
EV-UMBRA-ADV-WG-1200-EM-TRI (12187)	50%	19W	21W	0.7W	3W
EV-UMBRA-ADV-WG-1200-EM-TRI (12187)	100%	36W	38W	0.7W	3W

## 600MM SPACING TABLE (DISTANCE BETWEEN FITTINGS)

Lx	Classification	Mounting Height (m)															
		2.1	2.4	2.7	3.0	3.3	3.6	4.0	4.5	5.0	6.0	7.0	8.0	9.0	10	15	20
0.2	D63	11.5	13.2	14.8	16.5	18.1	19.8	22.0	24.5	25.2	26.4	27.3	28.0	28.5	28.8	27.9	0.0 <sup>4</sup>
	D32	11.5	13.2	14.8	16.5	17.6	18.0	18.5	19.0	19.5	20.1	20.5	20.7	20.6	20.3	0.0 <sup>4</sup>	N/A

## 1200MM SPACING TABLE (DISTANCE BETWEEN FITTINGS)

Lx	Classification	Mounting Height (m)															
		2.1	2.4	2.7	3.0	3.3	3.6	4.0	4.5	5.0	6.0	7.0	8.0	9.0	10	15	20
0.2	D63	11.5	13.2	14.8	16.5	18.1	19.8	22.0	24.5	25.2	26.4	27.3	28.0	28.5	28.8	27.9	0.0 <sup>4</sup>
	D40	11.5	13.2	14.8	16.5	18.1	19.5	20.1	20.7	21.2	22.1	22.6	23.0	23.1	23.0	0.0 <sup>4</sup>	N/A

\*Care should be taken when spacing luminaires at the distance indicated by shaded regions to ensure that conformance to AS/NZS 2293.1:2018 Clause 4.3 is maintained (e.g. maximum 500m² per emergency luminaire).

## ORDERING INFORMATION

SKU	Product code	Product number	Description
12180	EV-UMBRA-ADV-DIFF-600-TRI	9336462121801	Advanced 600 mm Diffused Batten
12181	EV-UMBRA-ADV-DIFF-600-EM-TRI	9336462121818	Advanced 600 mm Diffused Emergency Batten
12182	EV-UMBRA-ADV-DIFF-600-S-TRI	9336462121825	Advanced 600 mm Diffused Batten with sensor
12183	EV-UMBRA-ADV-DIFF-600-EM-S-TRI	9336462121832	Advanced 600 mm Diffused Emergency Batten with sensor
12184	EV-UMBRA-ADV-DIFF-1200-TRI	9336462121849	Advanced 1200 mm Diffused Batten
12185	EV-UMBRA-ADV-WG-1200-TRI	9336462121856	Advanced 1200 mm Wireguard Batten
12186	EV-UMBRA-ADV-DIFF-1200-EM-TRI	9336462121863	Advanced 1200 mm Emergency Diffused Batten
12187	EV-UMBRA-ADV-WG-1200-EM-TRI	9336462121870	Advanced 1200 mm Wireguard Emergency Batten
12188	EV-UMBRA-ADV-DIFF-1200-S-TRI	9336462121887	Advanced 1200 mm Diffused Batten with sensor
12189	EV-UMBRA-ADV-DIFF-1200-EM-S-TRI	9336462121894	Advanced 1200 mm Diffused Emergency Batten with sensor

## ACCESSORIES AND SPARE PARTS

SKU	Product code	Product number	Description
01302	EV-1500mAh-6,4V-LiFePO4	9336462013038	Battery Stick 1500mAh 6,4V 2 Cell LiFePO4 Battery

### REPLACING THE BATTERY

Access the battery by removing the gear tray. Disconnect and remove battery. Replace battery as was previously installed. Battery can be connected in one direction only, do not force. Allow a minimum 24 hours charging time before carrying out any discharge tests as per the requirements in AS/NZS 2293.

### WARNING

The Ektor Umbra Advanced Emergency Luminaire is connected to an unswitched active during normal operating conditions. When disconnected from the mains supply, the Umbra Adv is powered by a LiFePO4 battery operated inverter. Due to this, care should be taken when replacing the battery.

### BATTERY LIFE

To maintain the economic life of this product it is required that the battery be discharged and recharged at least once every 6 months. The battery life can be reduced if the battery is not discharged as per the requirements of AS/NZS 2293 or an equivalent standard. Increasing the number of duration tests above that as defined in AS/NZS 2293 or an equivalent standard can have a positive effect on the battery performance as long as 12 discharge cycles per year is not exceeded. The recharging device will operate normally after removal of short circuit fault.

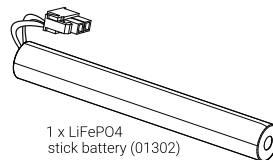

1 x LiFePO4 stick battery (01302)

### POWER / LUMEN DIP SWITCH INSTRUCTIONS

To adjust the total lumen output: With the mains turned off, please adjust power output via the DIP Switch located on the driver.

#### DIP Switch selection



DIP SWITCH

Position	Power
OFF	50%
ON	100%

**WARRANTY STATEMENT**

Ektor products are distributed in Australia and New Zealand by Evolt Pty Ltd (Evolt). The Australian Consumer Law as well as other Australian laws guarantee certain conditions, warranties and undertakings, and give you other legal rights, in relation to the quality and fitness for purpose of Ektor products sold in Australia. In Australia, our goods come with guarantees that cannot be excluded under the Australian Consumer Law. You are entitled to a replacement or refund for a major failure and compensation for any other reasonably foreseeable loss or damage. You are also entitled to have the goods repaired or replaced if the goods fail to be of acceptable quality and the failure does not amount to a major failure. What constitutes a major failure is set out in the Australian Consumer Law. Nothing in this Warranty purports to modify or exclude the conditions, warranties and undertakings, and other legal rights, under the Australian Competition and Consumer Act and other Australian laws. Ektor products are warranted in Australia for a period of 3 years from the date of delivery of the product, provided that the products are properly stored, installed, used and maintained in accordance with the instructions contained within their manual. Products that have been altered in any way or used other than in accordance with their instructions are not covered by this warranty.

This warranty is not transferable and is valid only in the hands of the purchaser of the product. The warranty does not cover Ektor products other than those purchased from Evolt. Proof of purchase must be provided to Evolt with any warranty claim. Evolt recommends that the purchaser attaches their proof of purchase to their product manual. Evolt's total liability under this warranty is limited to the cost of repair or replacement of the faulty product. Evolt may satisfy its obligations under this warranty in full by repair or replacement of a faulty product. This warranty does not apply to consumable items such as lamps or batteries or other items that can be classified as consumable. For the avoidance of any doubt, any and all warranties or conditions which are not guaranteed under the Australian Competition and Consumer Act or the Australian Competition and Consumer Regulations 2010 and which are not expressly included in this Warranty as additional warranties or conditions are excluded. This Warranty does not cover loss or damage caused by wear and tear, misuse, incorrect installation or operation, failure to clean and maintain, incorrect voltage or non-authorised electrical connections, adverse external conditions (such as power surges and dips, acts of God, exposure to heat, corrosion, insect or vermin infestation), use of non-authorised or defective parts or globes, or to items that have been repaired other than by Evolt or a repairer approved by Evolt.

**TECHNICAL SUPPORT AND TROUBLESHOOTING**

For further assistance in using this product, consult your nearest wholesaler or Evolt Pty Limited